

GV-VD320D /321D / 322D / 323D 3MP H.264 IR Vandal Proof IP Dome



- 1/2.5" progressive scan CMOS
- Stream 1 from H.264 and MJPEG; Stream 2 from H.264, MPEG4 and MJPEG
- Up to 20 fps at 2048 x 1536
- IK10+ rating (for GV-VD320D and GV-VD321D only)
- IK7 rating (for GV-VD322D and GV-VD323D only)
- IP66 rating
- 3-axis mechanism (pan / tilt / roll)
- Removable IR-cut filter for Day/Night function
- External microphone
- Intelligent IR
- 2-way audio
- One sensor input and alarm output
- TV-out support
- Micro SD/SDHC Card Slot
- DC12V / AC24V / PoE
- Motion detection
- Tampering alarm
- Privacy mask
- IP address filtering
- Supports iPhone, iPad, Android & 3GPP
- 31 languages on Web interface

No SD/SDHC card slot & local storage function for Argentina

Models

| Model | Housing Cover Cover Color | Vandal Resistance |
|-----------|------------------------------|-------------------|
| GV-VD320D | Transparent cover | IK10+ |
| GV-VD321D | Smoked cover | IK10+ |
| GV-VD322D | Transparent cover | IK7 |
| GV-VD323D | Smoked cover | IK7 |

Active Tampering Alarm

Tampered



Focus Change



Camera Shift

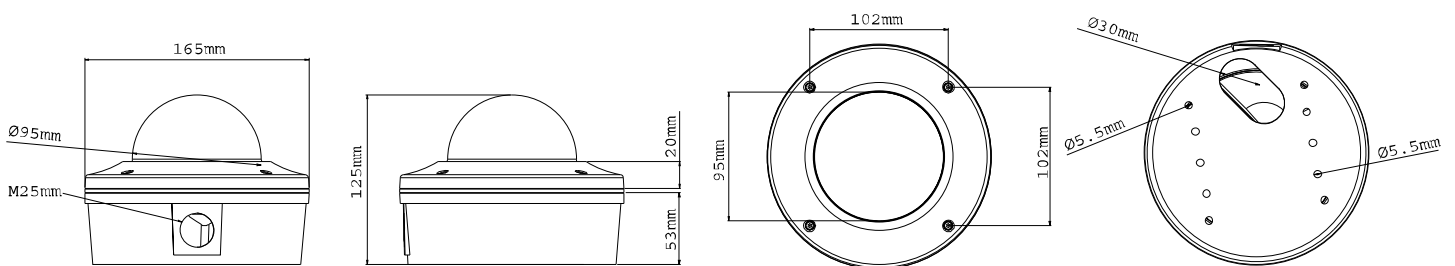

SPECIFICATIONS

| Camera | | |
|-------------------------|---|--|
| Image Sensor | 1/2.5" progressive scan CMOS | |
| Picture Elements | 2048 (H) x 1536 (V) | |
| Minimum Illumination | Color | 1 Lux (1/30 sec), 0.5 Lux (1/5 sec) |
| | B/W IR ON | 0 Lux |
| Shutter Speed | Automatic, Manual (1/5 ~ 1/8000 sec) | |
| White Balance | Automatic, Manual (2800K ~ 8500K) | |
| Lens | | |
| Megapixel | Yes | |
| Day / Night | Yes (with removable IR-cut filter) | |
| Lens Type | Varifocal | |
| Focal Length | 2.7 ~ 9 mm | |
| Maximum Aperture | F/1.3 | |
| Mount | Ø 14 mm | |
| Angle of View | Diagonal | 118.4° (W) ~ 36.3° (T) |
| | Horizontal | 94.7° (W) ~ 29° (T) |
| | Vertical | 71.1° (W) ~ 21.8° (T) |
| Operation | Focus | Manual (w / lock) |
| | Zoom | Manual (w / lock) |
| | Iris | DC drive |
| IR LED Quantity | 15 IR LEDs | |
| IR Distance | 15 m / 50 ft (Max.) | |
| Operation | | |
| Video Compression | H.264, MPEG4, MJPEG | |
| Video Stream | Stream 1 from H.264 and MJPEG Stream 2 from H.264, MPEG4 and MJPEG | |
| Frame Rate | 20 fps at 2048 x 1536 * The frame rate and the performance may vary depending on the number of connections and data bitrates (different scenes). | |
| Image Setting | Brightness, Contrast, Sharpness, Gamma, White Balance, Flicker-less, Image Orientation, Backlight Compensation, D/N Sensitivity, Shutter Speed | |
| Audio Compression | G.711, AAC (16 kHz / 16 bit) * AAC is only supported by GV-System V8.5 or later | |
| Two-way Audio | Yes | |
| Sensor Input | 1 Input (Dry Contact) | |
| Alarm Output | 1 Digital Output (200mA 5V DC) | |
| Video Resolution | | |
| Main Stream | 4:3 | 2048 x 1536, 1600 x 1200, 1280 x 960, 640 x 480, 320 x 240 |
| | 16:9 | 1920 x 1080, 1280 x 720, 640 x 360, 448 x 252 |
| | 5:4 | 1280 x 1024, 640 x 512, 320 x 256 |
| Sub Stream | 4:3 | 640 x 480, 320 x 240 |
| | 16:9 | 640 x 360, 448 x 252 |
| | 5:4 | 640 x 512, 320 x 256 |
| Network | | |
| Interface | 10/100 Ethernet | |
| Ethernet Protocol | HTTP, HTTPS, TCP, UDP, SMTP, FTP, DHCP, NTP, UPnP, DynDNS, 3GPP/ISMA, RTSP, PSIA, SNMP, QoS (DSCP) | |
| Mechanical | | |
| Lens Mounting | Ø 14 mm | |
| Temperature Detector | Yes | |
| Camera Angle Adjustment | Pan | 0° ~ 350° |
| | Tilt | 10° ~ 90° |
| | Rotate | 0° ~ 340° |

| | | |
|------------|---------------|--|
| Connectors | Power | 3-pin terminal block, PoE |
| | Ethernet | RJ-45 |
| | Audio | 1 In (RCA female for microphone) 1 Out (RCA female for speaker) |
| | Digital I/O | I/O Wires |
| | Auto Iris | DC drive |
| | Local Storage | Micro SD/SDHC memory card slot (for Class 6 card or above) |
| | TV-Out | BNC connector (640 x 480). |

| General | | |
|---------------------------|---------------------------------|---------------------------------|
| Environment Temperature | -20 °C ~ 50 °C / 4 °F ~ 122 °F | |
| Humidity | 10% to 90% (no condensation) | |
| Power Source | 12V DC / 24V AC / PoE | |
| Max. Power Consumption | 12 W | |
| Dimensions | Camera Body | ø 165 x 125 mm / 6.49 x 4.92 in |
| | Cable Length | 1 m / 3.28 ft |
| | Cable Diameter | ø 16.7 mm / 0.66 in |
| | Maximum Connector Diameter | ø16.7 mm / 0.66 in |
| Weight | 1.7 kg / 3.75 lb | |
| Protection Classification | IP66 | |
| Protection Classification | IP66 | |
| Vandal Resistance | GV-VD320D / GV-VD321D | IK10+ |
| | GV-VD322D / GV-VD323D | IK7 |
| Regulatory | CE, FCC, C-Tick, RoHS compliant | |

| Power over Ethernet | | |
|-----------------------|---|--|
| PoE Standard | IEEE 802.3af Power over Ethernet / PSE | |
| PoE Power Supply Type | End-Span | |
| PoE Power Output | Per Port 48V DC, 350mA. Max. 15.4 watts | |

| Web Interface | | |
|-------------------------|--|--|
| Installation Management | Web-based configuration | |
| Maintenance | Firmware upgrade through Web Browser or Utility | |
| Access from Web Browser | Camera live view, video recording, change video quality, bandwidth control, image snapshot, digital I/O control, audio, Wide Angle Lens Dewarping, Picture in Picture, Picture and Picture, Privacy Mask, Visual Automation, Tampering Alarm, Text Overlay | |
| Language | Arabic / Bulgarian / Czech / Danish / Dutch / English / Finnish / French / German / Greek / Hebrew / Hungarian / Indonesian / Italian / Japanese / Lithuanian / Norwegian / Persian / Polish / Portuguese / Romanian / Russian / Serbian / Simplified Chinese / Slovakian / Slovenian / Spanish / Swedish / Thai / Traditional Chinese / Turkish | |

| Applications | | |
|----------------------|--|--|
| Network Storage | GV-NVR, GV-System, GV-Backup Center, GV-Recording Server | |
| Mobile Phone support | GV-AView for Android Smartphone, GV-Eye HD for iPad, GV-Eye for iPhone and iPod Touch, GV-GView for Windows PDA, GV-MSView for Windows Smartphone, GV-SSView for Symbian Smartphone, 3G-enabled phone. | |
| Live Viewing | IE , GV-MultiView | |
| CMS Server support | GV-Control Center, GV-Center V2, GV-VSM | |

Note:

1. Do not use clothes or any ordinary material to clean the camera cover since they may result in scratches.
2. Specifications are subject to change without notice.